



# POST-DISINFECTION CORONAVIRUS-19 FIELD VERIFICATION TESTING REPORT

---

CLIENT: Mitchell Gayer  
NJIT  
333 Martin Luther King Blvd  
Newark, NJ 07102

SITE LOCATION: NJIT  
333 Martin Luther King Blvd  
Newark, NJ 07102

SCOPE OF WORK: COVID-19 Verification Testing

AREAS TESTED: Campus Wide

CLIENT CONTACT(S): Mitchell Gayer

SITE EVALUATION CONDUCTED: 9/02-03/2020

DATE OF REPORT: 9/04/2020

REPORT PREPARED BY: Kadeem Hill

REPORT REVIEWED BY: Veronica Kero P.E., CIH

{Omega Project#: 20-1175}

## Table of Contents

<b><u>Executive Summary</u></b>	3
<b><u>Project Overview</u></b>	3
<ul style="list-style-type: none"><li>• Project Overview/Scope of Work</li><li>• Bio-Load and COVID-19 Field Sampling &amp; Analysis Protocol</li></ul>	
<b><u>ATP Direct Read: Bioluminescence</u></b>	4
<ul style="list-style-type: none"><li>• ATP Direct Read Meter Data</li><li>• Data Interpretation</li><li>• Field Notes</li><li>• Site Illustrations</li></ul>	
<b><u>COVID-19 PCR DNA Sequencing</u></b>	13
<ul style="list-style-type: none"><li>• COVID-19 PCR DNA Swab Sample Results</li><li>• Data Interpretation</li></ul>	
<b><u>Attachments</u></b>	16
<ul style="list-style-type: none"><li>• Laboratory analysis reports with chain-of-custody</li></ul>	

Executive Summary:

On 9/2/20 and 9/3/20 Omega Environmental Services conducted Coronavirus verification testing in Tiernan Hall, Kupfrian Hall, Faculty Memorial Hall (FMH), and Guttenberg Information Technologies Center (GITC) of the NJIT campus. The purpose of this testing was to document adequate disinfection and cleaning by the NJIT maintenance staff.

Parameter	Results
Adenosine Triphosphate (ATP) Direct Reads: Bioluminescence Meter (Detects Bacteria and Bio-Load)	<ul style="list-style-type: none"><li>•13 out of the 146 samples resulted in elevated ATP levels.</li><li>•9 out of the 13 surfaces with elevated ATP levels were re-cleaned by NJIT Building Services and retested. Retest results indicated acceptable levels of ATP on the 9 surfaces.</li><li>•The 4 surfaces that were not re-cleaned were sampled for SARS-CoV-2.</li></ul>
Coronavirus-19 PCR Swab	<ul style="list-style-type: none"><li>•Laboratory results indicates all the SARS-Cov-2 samples taken on 9/2/20 and 9/3/20 were negative</li></ul>

**Bio-Load and COVID-19 Field Sampling & Analysis Protocol:**

While a COVID-19 PCR DNA sequencing field testing method has become available, pre-screen methods that apply to overall bacteria cleaning are being employed to more efficiently clear areas and reduce testing costs.

- **REAL-TIME FIELD SCREEN USING ATP DIRECT-READ BIO-LUMINESCENCE METER AND WHITE CLOTH TESTS:** Omega field IH to inspect room and collect ATP swabs on all component basis to assess overall cleaning thoroughness. If there are ATP swab results statistically above “typical background,” re-cleaning of the room will be requested followed by repeat ATP testing before proceeding with further testing.
- **COVID-19 PCR DNA SEQUENCING METHOD:** Once a room passes above described bio-load testing protocols, a COVID-19 PCR swab will be collected from alternating room locations.
- **COVID-19 PCR AIR SAMPLING METHOD:** Air samples are collected using a linear oscillating pump in conjunction with a 0.3 µm Polytetrafluoroethylene (PTFE) filter housed 37 mm cassettes. The pump pulls the air from the surrounding area into the cassette where any airborne virus particulates are captured. The samples are collected at a flow rate of 15 liters per minute (LPM), for 2 hours, totaling 1800 liters. Once sampling is complete, samples are shipped to an independent laboratory for analysis. Samples are analyzed via a polymerase chain reaction (PCR) method. The PCR method relies on a protein responsible for DNA replication in cells, please note this protein will only replicate DNA strands that match the COVID-19 sequence. If replication exceeds a threshold established by the laboratory the sample is determined to be positive for the COVID-19 strand. Test results should be used as metrics for cleaning success rather than a direct estimator for infection potential.

**Definitions:**

ATP - Adenosine Triphosphate

HPC - Heterotrophic Plate Count

PCR - Polymerase Chain Reaction Polymerase

RLU – Relative Light Unit

**ATP Direct Read: Bio-Luminescence Meter (*Hygiena/Ensure*) Data:**

Test No.	Date	Building	Room	Surface	RLU Result	Lower Control Limit	Upper Control Limit	Notes
1	09/02/2020 03:08 PM	Tiernan Hall	TLH1	Hot Water Faucet Handle	32	105	211	
2	09/02/2020 03:09 PM	Tiernan Hall	TLH1	Cold Water Faucet Handle	0	105	211	
3	09/02/2020 03:10 PM	Tiernan Hall	TLH1	Row A, Seat 8, Table	45	105	211	
4	09/02/2020 03:11 PM	Tiernan Hall	TLH1	Row A, Seat 7, Table	542	105	211	
5	09/02/2020 03:12 PM	Tiernan Hall	TLH1	Row A, Seat 6, Table	175	105	211	
6	09/02/2020 03:18 PM	Tiernan Hall	TLH1	Extron Tablet	38	105	211	
7	09/02/2020 03:19 PM	Tiernan Hall	TLH1	Row A, Seat 3, Table	3	105	211	
8	09/02/2020 03:20 PM	Tiernan Hall	TLH1	Row C, Seat 3, Table	923	105	211	
9	09/02/2020 03:24 PM	Tiernan Hall	TLH1	Row C, Seat 4, Table	224	105	211	
10	09/02/2020 03:27 PM	Tiernan Hall	TLH1	Row C, Seat 6, Table	404	105	211	
11	09/02/2020 03:37 PM	Tiernan Hall	TLH1	Left Door Push Bar	5	105	211	Near Chemical Fume Hood
12	09/02/2020 03:38 PM	Tiernan Hall	TLH1	Right Door Push Bar	12	105	211	Door located across the hall from room 199E

13	09/02/2020 04:10 PM	Tiernan Hall	TLH1	Row A, Seat 7, Table	194	105	211	Sample No. 4 Retest
14	09/02/2020 04:11 PM	Tiernan Hall	TLH1	Row C, Seat 3, Table	95	105	211	Sample No. 8, Retest
15	09/02/2020 04:12 PM	Tiernan Hall	TLH1	Row C, Seat 4, Table	36	105	211	Sample No. 9 Retest
16	09/02/2020 04:13 PM	Tiernan Hall	TLH1	Row C, Seat 6, Table	56	105	211	Sample No. 10, Retest
17	09/02/2020 04:14 PM	Tiernan Hall	TLH1	Row C, Seat 7, Table	14	105	211	
18	09/02/2020 04:15 PM	Tiernan Hall	TLH1	Row C, Seat 9, Table	49	105	211	
19	09/02/2020 04:15 PM	Tiernan Hall	TLH1	Row C, Seat 11, Table	40	105	211	
<b>20</b>	<b>09/02/2020 04:17 PM</b>	<b>Tiernan Hall</b>	<b>TLH1</b>	<b>Row E, Seat 12, Table</b>	<b>2015</b>	<b>105</b>	<b>211</b>	
21	09/02/2020 04:20 PM	Tiernan Hall	TLH1	Row E, Seat 5, Table	76	105	211	
22	09/02/2020 04:21 PM	Tiernan Hall	TLH1	Row E, Seat 1, Table	128	105	211	
23	09/02/2020 04:22 PM	Tiernan Hall	TLH1	Row G, Seat 4, Table	41	105	211	
24	09/02/2020 04:23 PM	Tiernan Hall	TLH1	Row G, Seat 7, Table	30	105	211	
25	09/02/2020 04:23 PM	Tiernan Hall	TLH1	Row G, Seat 11, Table	34	105	211	
26	09/02/2020 04:25 PM	Tiernan Hall	TLH1	Row I, Seat 11, Table	62	105	211	
27	09/02/2020 04:26 PM	Tiernan Hall	TLH1	Row I, Seat 5, Table	6	105	211	
28	09/02/2020 04:26 PM	Tiernan Hall	TLH1	Row I, Seat 2, Table	20	105	211	
29	09/02/2020 04:28 PM	Tiernan Hall	TLH1	Row K, Seat 1, Table	36	105	211	
30	09/02/2020 04:28 PM	Tiernan Hall	TLH1	Row K, Seat 12, Table	20	105	211	

31	09/02/2020 04:29 PM	Tiernan Hall	TLH1	Row K, Seat 8, Table	45	105	211	
32	09/02/2020 04:29 PM	Tiernan Hall	TLH1	Stair Rail	6	105	211	Bottom of the right stair rail
33	09/02/2020 04:52 PM	Tiernan Hall	TLH2	Row A, Seat 1, Table	31	105	211	
34	09/02/2020 04:53 PM	Tiernan Hall	TLH2	Row A, Seat 5, Table	9	105	211	
35	09/02/2020 04:53 PM	Tiernan Hall	TLH2	Row A, Seat 9, Table	0	105	211	
36	09/02/2020 04:55 PM	Tiernan Hall	TLH2	Row C, Seat 10, Table	6	105	211	
37	09/02/2020 04:55 PM	Tiernan Hall	TLH2	Row C, Seat 6, Table	12	105	211	
38	09/02/2020 04:56 PM	Tiernan Hall	TLH2	Row C, Seat 2, Table	3	105	211	
39	09/02/2020 04:58 PM	Tiernan Hall	TLH2	Row E, Seat 2, Table	29	105	211	
40	09/02/2020 04:58 PM	Tiernan Hall	TLH2	Row E, Seat 6, Table	17	105	211	
41	09/02/2020 04:59 PM	Tiernan Hall	TLH2	Row E, Seat 10, Table	21	105	211	
42	09/02/2020 05:00 PM	Tiernan Hall	TLH2	Row G, Seat 1, Table	85	105	211	
43	09/02/2020 05:01 PM	Tiernan Hall	TLH2	Row G, Seat 5, Table	9	105	211	
44	09/02/2020 05:01 PM	Tiernan Hall	TLH2	Row G, Seat 9, Table	55	105	211	
45	09/02/2020 05:04 PM	Tiernan Hall	TLH2	Row J, Seat 2, Table	33	105	211	
46	09/02/2020 05:04 PM	Tiernan Hall	TLH2	Row J, Seat 5, Table	9	105	211	
47	09/02/2020 05:05 PM	Tiernan Hall	TLH2	Row J, Seat 9, Table	50	105	211	
<b>48</b>	<b>09/02/2020 05:07 PM</b>	<b>Tiernan Hall</b>	<b>TLH2</b>	<b>Row J, Seat 13, Table</b>	<b>358</b>	<b>105</b>	<b>211</b>	

49	09/02/2020 05:10 PM	Tiernan Hall	TLH2	Row L, Seat 5, Table	10	105	211	
50	09/02/2020 05:10 PM	Tiernan Hall	TLH2	Row L, Seat 13, Table	14	105	211	
51	09/02/2020 05:11 PM	Tiernan Hall	TLH2	Row L, Seat 14, Table	15	105	211	
52	09/02/2020 05:11 PM	Tiernan Hall	TLH2	Right Stair Rail	17	105	211	Top of the right stair rail, looking into the stands
53	09/02/2020 05:12 PM	Tiernan Hall	TLH2	Right Door Bar	9	105	211	Across the hall from room 015A
54	09/02/2020 05:25 PM	Tiernan Hall	108	Door Handle	97	105	211	Classroom side of the door
55	09/02/2020 05:26 PM	Tiernan Hall	108	Extron Control Box	2	105	211	
56	09/02/2020 05:27 PM	Tiernan Hall	108	Row A, Seat 1, Table	14	105	211	
57	09/02/2020 05:28 PM	Tiernan Hall	108	Row A, Seat 3, Table	16	105	211	
58	09/02/2020 05:28 PM	Tiernan Hall	108	Row A, Seat 5, Table	90	105	211	
59	09/02/2020 05:29 PM	Tiernan Hall	108	Cisco Tablet Screen	9	105	211	
60	09/02/2020 05:30 PM	Tiernan Hall	108	Row B, Seat 1, Table	7	105	211	
61	09/02/2020 05:31 PM	Tiernan Hall	108	Row B, Seat 3, Table	27	105	211	
62	09/02/2020 05:31 PM	Tiernan Hall	108	Row B, Seat 5, Table	6	105	211	
63	09/02/2020 05:32 PM	Tiernan Hall	108	Row C, Seat 1, Table	8	105	211	
64	09/02/2020 05:33 PM	Tiernan Hall	108	Row C, Seat 3, Table	8	105	211	
65	09/02/2020 05:33 PM	Tiernan Hall	108	Row C, Seat 5, Table	11	105	211	
66	09/02/2020 05:33 PM	Tiernan Hall	108	Instructor's Podium	3	105	211	

67	09/02/2020 05:36 PM	Tiernan Hall	108	Row D, Seat 1, Table	8	105	211	
68	09/02/2020 05:37 PM	Tiernan Hall	108	Row E, Seat 3, Table	9	105	211	
69	09/02/2020 05:37 PM	Tiernan Hall	108	Row F, Seat 5, Table	8	105	211	
70	09/02/2020 05:38 PM	Tiernan Hall	108	Row G, Seat 1, Table	10	105	211	
71	09/02/2020 05:38 PM	Tiernan Hall	108	Door Handle	141	105	211	Hallway side of the door
72	09/03/2020 12:09 PM	Kupfrian Hall	210	Light Switch	6	105	211	Located near the podium
73	09/03/2020 12:10 PM	Kupfrian Hall	210	Extron Control Box	182	105	211	
74	09/03/2020 12:11 PM	Kupfrian Hall	210	Cisco Tablet Screen	42	105	211	
75	09/03/2020 12:12 PM	Kupfrian Hall	210	Instructor's Podium	816	105	211	Located in the back of the room
76	09/03/2020 12:14 PM	Kupfrian Hall	210	Light Switch	4	105	211	
77	09/03/2020 12:15 PM	Kupfrian Hall	210	Row A, Seat 1, Table	20	105	211	
78	09/03/2020 12:16 PM	Kupfrian Hall	210	Row A, Seat 5, Table	49	105	211	
79	09/03/2020 12:17 PM	Kupfrian Hall	210	Row C, Seat 4, Table	41	105	211	
80	<b>09/03/2020 12:17 PM</b>	<b>Kupfrian Hall</b>	<b>210</b>	<b>Row C, Seat 8, Table</b>	<b>388</b>	<b>105</b>	<b>211</b>	
81	09/03/2020 12:18 PM	Kupfrian Hall	210	Row G, Seat 1, Table	21	105	211	
82	09/03/2020 12:19 PM	Kupfrian Hall	210	Row G, Seat 6, Table	42	105	211	
83	09/03/2020 12:20 PM	Kupfrian Hall	210	Row J, Seat 13, Table	51	105	211	
84	09/03/2020 12:20 PM	Kupfrian Hall	210	Row I, Seat 1, Table	26	105	211	



85	09/03/2020 12:21 PM	Kupfrian Hall	210	Row J, Seat 3, Table	64	105	211	
86	09/03/2020 12:22 PM	Kupfrian Hall	210	Row I, Seat 6, Table	17	105	211	
87	09/03/2020 12:22 PM	Kupfrian Hall	210	Row I, Seat 4, Table	25	105	211	
88	09/03/2020 12:23 PM	Kupfrian Hall	210	Row I, Seat 8, Table	72	105	211	
89	09/03/2020 01:11 PM	Faculty Memorial Hall (FMH)	204	Column A, Seat 1, Table	6	105	211	
90	09/03/2020 01:13 PM	FMH	204	Column A, Seat 3, Table	5	105	211	
91	09/03/2020 01:14 PM	FMH	204	Column A, Seat 5, Table	26	105	211	
92	09/03/2020 01:15 PM	FMH	204	Column A, Seat 7, Table	39	105	211	
93	09/03/2020 01:16 PM	FMH	204	Column A, Seat 9, Table	18	105	211	
94	09/03/2020 01:18 PM	FMH	204	Column B, Seat 2, Table	19	105	211	
95	09/03/2020 01:19 PM	FMH	204	Instructor's Desk	0	105	211	
96	09/03/2020 01:20 PM	FMH	204	Column C, Seat 2, Table	22	105	211	
97	09/03/2020 01:20 PM	FMH	204	Column C, Seat 5, Table	15	105	211	
98	09/03/2020 01:21 PM	FMH	204	Column D, Seat 2, Table	29	105	211	
99	09/03/2020 01:22 PM	FMH	204	Column D, Seat 3, Table	12	105	211	
100	09/03/2020 01:22 PM	FMH	204	Column D, Seat 5, Table	9	105	211	
101	09/03/2020 01:23 PM	FMH	204	Column E, Seat 1, Keyboard	11	105	211	

102	09/03/2020 01:25 PM	FMH	204	Column F, Seat 2, Table	11	105	211	
103	09/03/2020 01:26 PM	FMH	204	Column F, Seat 4, Table	16	105	211	
104	09/03/2020 01:26 PM	FMH	204	Column F, Seat 6, Table	17	105	211	
105	09/03/2020 01:26 PM	FMH	204	Column F, Seat 8, Table	18	105	211	
106	09/03/2020 01:27 PM	FMH	204	Column F, Seat 10, Table	7	105	211	
107	09/03/2020 01:29 PM	FMH	204	Back Left Door Handle	12	105	211	Classroom side of Door
108	09/03/2020 01:30 PM	FMH	204	Front Right Door Handle	42	105	211	Classroom side of Door
109	09/03/2020 01:35 PM	FMH	204	Column A, Seat 5, Keyboard	6	105	211	
110	09/03/2020 01:36 PM	FMH	204	Column F, Seat 9, Mouse	5	105	211	
111	09/03/2020 02:00 PM	Kupfrian Hall	202	Row A, Seat 2, Table	70	105	211	
<b>112</b>	<b>09/03/2020 02:02 PM</b>	<b>Kupfrian Hall</b>	<b>202</b>	<b>Row A, Seat 5, Table</b>	<b>246</b>	<b>105</b>	<b>211</b>	
113	09/03/2020 02:03 PM	Kupfrian Hall	202	Row A, Seat 7, Table	93	105	211	
114	09/03/2020 02:04 PM	Kupfrian Hall	202	Row B, Seat 1, Table	42	105	211	
115	09/03/2020 02:05 PM	Kupfrian Hall	202	Row B, Seat 3, Table	35	105	211	
116	09/03/2020 02:05 PM	Kupfrian Hall	202	Row B, Seat 6, Table	41	105	211	
117	09/03/2020 02:06 PM	Kupfrian Hall	202	Row B, Seat 8, Table	95	105	211	
118	09/03/2020 02:07 PM	Kupfrian Hall	202	Row C, Seat 2, Table	103	105	211	
<b>119</b>	<b>09/03/2020 02:08 PM</b>	<b>Kupfrian Hall</b>	<b>202</b>	<b>Row C, Seat 4, Table</b>	<b>215</b>	<b>105</b>	<b>211</b>	

120	09/03/2020 02:09 PM	Kupfrian Hall	202	Row C, Seat 5, Table	37	105	211	
121	09/03/2020 02:09 PM	Kupfrian Hall	202	Row C, Seat 7, Table	145	105	211	
122	09/03/2020 02:11 PM	Kupfrian Hall	202	Row D, Seat 1, Table	136	105	211	
<b>123</b>	<b>09/03/2020 02:12 PM</b>	<b>Kupfrian Hall</b>	<b>202</b>	<b>Row D, Seat 3, Table</b>	<b>295</b>	<b>105</b>	<b>211</b>	
<b>124</b>	<b>09/03/2020 02:17 PM</b>	<b>Kupfrian Hall</b>	<b>202</b>	<b>Row A, Seat 5, Table</b>	<b>295</b>	<b>105</b>	<b>211</b>	<b>Sample No. 112 Retest</b>
<b>125</b>	<b>09/03/2020 02:19 PM</b>	<b>Kupfrian Hall</b>	<b>202</b>	<b>Row C, Seat 4, Table</b>	<b>295</b>	<b>105</b>	<b>211</b>	<b>Sample No. 119 Retest</b>
126	09/03/2020 02:20 PM	Kupfrian Hall	202	Row C, Seat 4, Table	102	105	211	Sample No. 119 Retest
127	09/03/2020 02:21 PM	Kupfrian Hall	202	Row A, Seat 5, Table	188	105	211	Sample No. 112 Retest
128	09/03/2020 02:22 PM	Kupfrian Hall	202	Row D, Seat 3, Table	147	105	211	Sample No. 123 Retest
129	09/03/2020 03:50 PM	GITC	3700	Table 1, Seat A	70	105	211	
130	09/03/2020 03:51 PM	GITC	3700	Table 2, Seat C	13	105	211	
131	09/03/2020 03:53 PM	GITC	3700	Table 3, Seat B	13	105	211	
132	09/03/2020 03:54 PM	GITC	3700	Table 4, Seat D	99	105	211	
133	09/03/2020 03:54 PM	GITC	3700	Table 5, Seat A	38	105	211	
<b>134</b>	<b>09/03/2020 03:55 PM</b>	<b>GITC</b>	<b>3700</b>	<b>Table 6, Seat B</b>	<b>325</b>	<b>105</b>	<b>211</b>	
135	09/03/2020 03:56 PM	GITC	3700	Table 7, Seat C	10	105	211	
136	09/03/2020 03:57 PM	GITC	3700	Table 8, Seat D	11	105	211	
137	09/03/2020 03:59 PM	GITC	3700	Table 9, Seat A	186	105	211	

138	09/03/2020 04:00 PM	GITC	3700	Table 10, Seat B	20	105	211	
139	09/03/2020 04:01 PM	GITC	3700	Table 11, Seat C	34	105	211	
140	09/03/2020 04:03 PM	GITC	3700	Table 12, Seat D	10	105	211	
141	09/03/2020 04:04 PM	GITC	3700	Table 13, Seat A	27	105	211	
142	09/03/2020 04:07 PM	GITC	3700	Table 14, Seat B	36	105	211	
143	09/03/2020 04:08 PM	GITC	3700	Table 15, Seat C	7	105	211	
144	09/03/2020 04:10 PM	GITC	3700	Table 16, Seat D	67	105	211	
145	09/03/2020 04:10 PM	GITC	3700	Right Door Push Bar	20	105	211	Classroom side of the door, Located near room 3701
146	09/03/2020 04:12 PM	GITC	3700	Light Switch	103	105	211	Closest button to Room 3701

### **Field Notes**

- Seat numbering starts on the left side of the room, from the perspective on the instructor.
- Row A is the row closest to the instructor.
- All directions and labels are from the perspective on the instructor, looking towards the seats
- In Room 202 of Kupfrian Hall, multiple recleaning attempts were needed in order to reduce ATP concentrations to an acceptable level. Omega recommends NJIT confirm the cleaning solution used is not over diluted which would reduce the efficacy of the product.

### **Data Interpretation:**

- 13 out of the 146 samples resulted in elevated ATP levels.
- 9 out of the 13 surfaces with elevated ATP levels were recleaned by NJIT Building Services and retested. Retest results indicated acceptable levels of ATP on the 9 surfaces.
- The 4 surfaces that were not recleaned were sampled for SARS-CoV-2.

Site Illustrations

# Room 3700

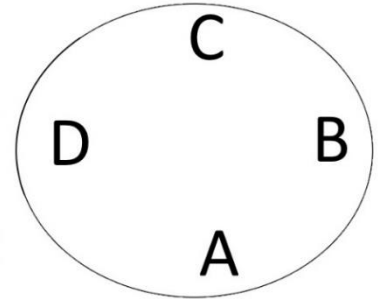

Seat A is always the seat closest to the right door

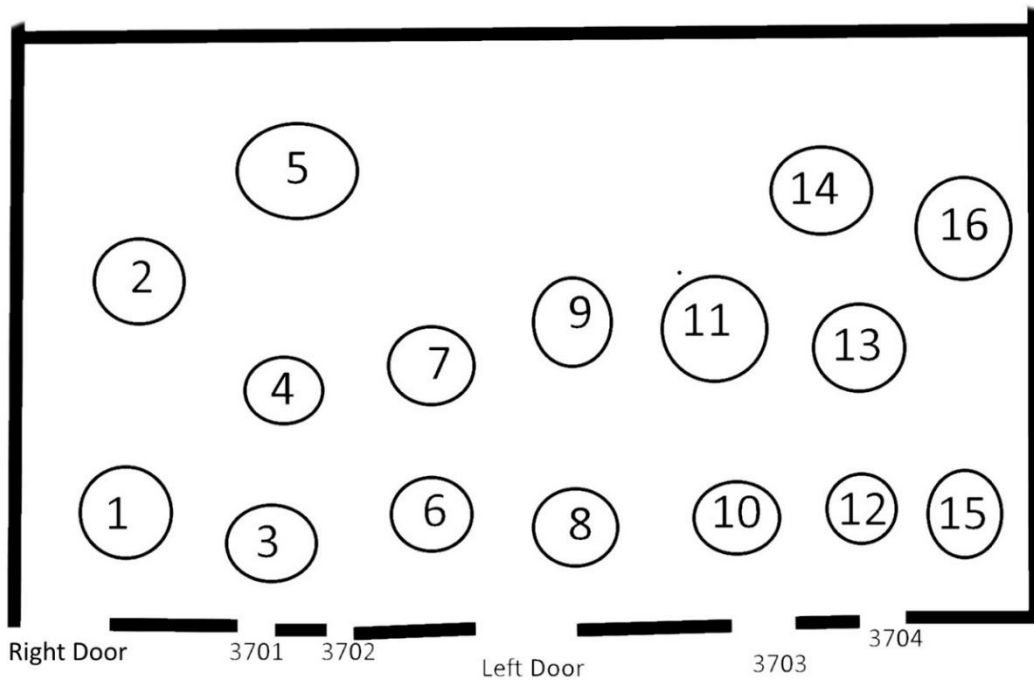

# FMH Room 204

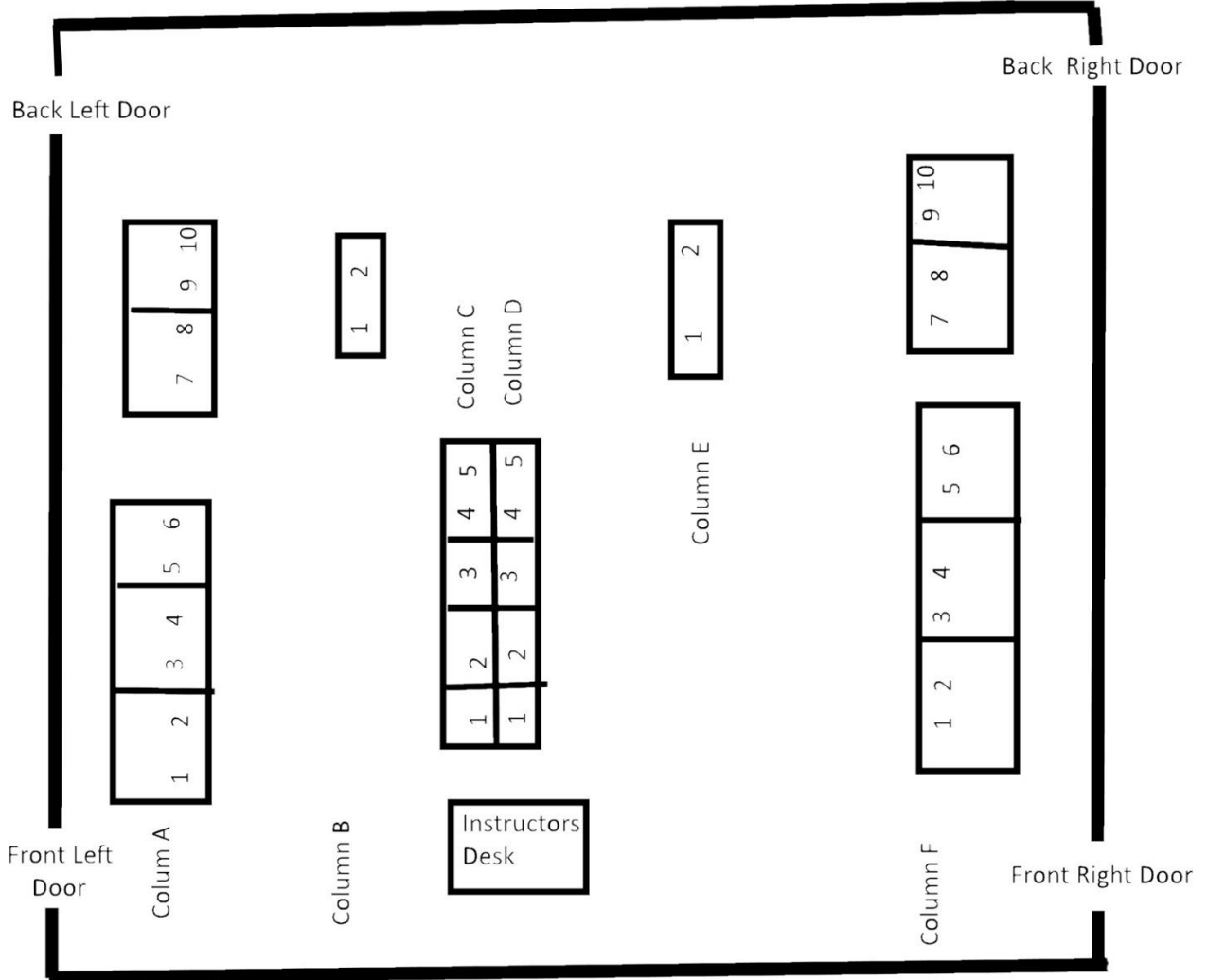

**COVID-19 Swab Data:**

Sample No.	COVID-19 Swab Location	Result (Positive/Negative)
1	Tiernan Hall, TLH1, Row A, Seat 7, Table	Negative
2	Tiernan Hall, TLH1, Row C, Seat 3, Table	Negative
3	Tiernan Hall, TLH1, Row C, Seat 6, Table	Negative
4	Tiernan Hall, TLH1, Row E, Seat 12, Table	Negative
5	Tiernan Hall, TLH1 Air Sample (Front of Lecture Hall) (Air Sample)	Negative
6	Tiernan Hall, TLH2 Air Sample (Front of Lecture Hall) (Air Sample)	Negative
7	Tiernan Hall, Room 108 Air Sample Front Room (Air Sample)	Negative
8	Tiernan Hall, TLH2 Row J, Seat 13, Table	Negative
9	Tiernan Hall, TLH2, Row A, Seat 1, Table	Negative
10	Tiernan Hall, TLH2, Row G, Seat 1, Table	Negative
11	Tiernan Hall, TLH2, Row G, Seat 9, Table	Negative
12	Tiernan Hall, Room 108, Row A, Seat 5	Negative
13	Tiernan Hall, Room 108 Podium	Negative
14	Tiernan Hall, Room 108 Hallway side of the Door Handle	Negative
15	Room 210, Kupfrian Hall, Podium	Negative
16	Room 210, Kupfrian Hall, Row C, Seat 8	Negative
17	Room 210, Kupfrian Hall, Extron Control	Negative
18	Faculty Memorial Building, Column A, Seat 6	Negative
19	Faculty Memorial Building, Column C, Seat 3	Negative
20	Faculty Memorial Building, Column F, Seat 5	Negative
21	Kupfrian Hall Room 202, Row A, Seat 5	Negative
22	Kupfrian Hall Room 202, Row C, Seat 4	Negative
23	Kupfrian Hall Room 202, Row D, Seat 3	Negative
24	GITC Room 3700, Table 6, Seat B	Negative
25	GITC Room 3700, Table 9, Seat A	Negative
26	GITC Room 3700, Light Switch	Negative
27	Kupfrian Hall, Hallway Outside of Rm 202 (Air Sample)	Negative
28	Faculty Memorial Hall Hallway Outside of Rm 204B (Air Sample)	Negative
29	GITC Hallway Outside of Rm 3700 (Air Sample)	Negative

**Data Interpretation:**

- Laboratory results indicates all the SARS-Cov-2 samples taken on 9/2/20 and 9/3/20 were negative



Attachments:

- *Laboratory analysis reports with chain-of-custody*

### Analytical Test Report

Client: Omega Environmental Services, Inc., 280 Huyler Street, South Hackensack, NJ 07606

Client Project/Name: 20-1175

Sample date: 9-3-2020

Submittal date: 9-3-2020

Sample received: 9-4-2020

Samples submitted by: Kadeem Hill

Date analysis completed: September 4, 2020

Prestige Report number: 200904-01

RT-PCR 2019-nCoV: Analysis of Swab samples for the detection of SARS-CoV-2 Genetic Markers

Prestige # Client sample ID Location	2019-nCoV (N1 Protein)	Cycle Threshold (Ct) Value <sup>3</sup> (N1 Protein)	2019-nCoV (N2 Protein)	Cycle Threshold Value <sup>3</sup> (N2 Protein)	Result
200904-01-001 01 Room 210, Kupfrian Hall, Podium	ND	ND	ND	ND	Negative
200904-01-002 02 Room 210, Kupfrian Hall, Row C, Seat 8	ND	ND	ND	ND	Negative
200904-01-003 03 Room 210, Kupfrian Hall, Exterior Control	ND	ND	ND	ND	Negative
200904-01-004 04 Faculty Memorial Building, Column A, Seat 6	ND	ND	ND	ND	Negative
200904-01-005 05 Faculty Memorial Building, Column C, Seat 3	ND	ND	ND	ND	Negative
200904-01-006 06 Faculty Memorial Building, Column F, Seat 5	ND	ND	ND	ND	Negative
200904-01-007 07 Kupfrian Room 202, Row A, Seat 5	ND	ND	ND	ND	Negative

200904-01-008 08 Kupfrian Room 202, Row C, Seat 4	ND	ND	ND	ND	Negative
--	----	----	----	----	----------

200904-01-009 09 Kupfrian Room 202, Row D, Seat 3	ND	ND	ND	ND	Negative
200904-01-013 13 GITC Room 3700, Table 6, Seat B	ND	ND	ND	ND	Negative
200904-01-014 14 GITC Room 3700, Table 9, Seat A	ND	ND	ND	ND	Negative
200904-01-015 15 GITC Room 3700, 48nt Switch	ND	ND	ND	ND	Negative

**RT-PCR 2019-nCoV: Analysis of Air samples for the detection of SARS-CoV-2 Genetic Markers**

Prestige # Client sample ID Location	2019-nCoV (N1 Protein)	Cycle Threshold (Ct) Value <sup>3</sup> (N1 Protein)	2019-nCoV (N2 Protein)	Cycle Threshold Value <sup>3</sup> (N2 Protein)	Result
200904-01-010 10 Kupfrian Hallway Outside of Rm 202	ND	ND	ND	ND	Negative
200904-01-011 11 Faculty Memorial Hall Hallway Outside of Rm 204B	ND	ND	ND	ND	Negative
200904-01-012 12 GITC Hallway Outside of Rm 3700	ND	ND	ND	ND	Negative

Report approved:



Theresa Lehman, MPH, Lab Director

Technical Manager: \_\_\_\_\_



Chin S Yang, Ph.D.

Analyst: Ching-Yi Tsai, Ph.D.

1. The samples in this report were received in good, acceptable conditions. Results relate only to the items tested.
2. The primers and probes in 2019-nCoV CDC EUA Kit are designed for the detection of the two SARS-CoV-2 genes that encode for the N1 and N2 proteins. The kit is manufactured and supplied by Integrated DNA Technologies and approved by the U.S. Centers for Disease Control and Prevention (CDC). Three controls, two positive controls for N proteins and one internal control for the RNA extraction process, are simultaneously run with the samples.
3. Cycle Threshold Value refers to the number of cycles required for the fluorescent signal to cross the detectable threshold in Reverse Transcriptase Polymerase Chain Reaction (RT-PCR); a lower cycle threshold value indicates a higher viral load.
4. ND = not detected, no genetic marker is detected within 40 PCR cycles. The detection limit is 10 copies/reaction.
5. Sampling reference: Rahmani, A. R., M. Leili, G. Azarian, A. Poormohammadi. 2020. Sampling and detection of corona viruses in air: A mini review. Science of the Total Environment.  
<https://doi.org/10.1016/j.scitotenv.2020.140207>

*Prestige EnviroMicrobiology, Inc.*

**Analytical Test Report**

Client: Omega Environmental Services, Inc., 280 Huyler Street, South Hackensack, NJ 07606

Client Project/Name: 20-1177

Sample date: 9-2-2020

Submittal date: 9-2-2020

Sample received: 9-3-2020

Samples submitted by: Kadeem Hill

Date analysis completed: September 3, 2020

Prestige Report number: 200903-05

RT-PCR 2019-nCoV: Analysis of Swab samples for the detection of SARS-CoV-2 Genetic Markers

Prestige # Client sample ID Location	2019-nCoV (N1 Protein)	Cycle Threshold (Ct) Value <sup>3</sup> (N1 Protein)	2019-nCoV (N2 Protein)	Cycle Threshold Value <sup>3</sup> (N2 Protein)	Result
200903-05-101 01 TLH1, Row A, Seat 7, Table	ND	ND	ND	ND	Negative
200903-05-102 02 TLH1, Row C, Seat 3, Table	ND	ND	ND	ND	Negative
200903-05-103 03 TLH1, Row C, Seat 6, Table	ND	ND	ND	ND	Negative
200903-05-104 04 TLH1, Row E, Seat 12, Table	ND	ND	ND	ND	Negative
200903-05-108 08 TLH2, Row S, Seat 13, Table	ND	ND	ND	ND	Negative
200903-05-109 09 TLH2, Row A, Seat 1, Table	ND	ND	ND	ND	Negative
200903-05-110 10 TLH2, Row G, Seat 1, Table	ND	ND	ND	ND	Negative
200903-05-111 11 TLH2, Row G, Seat 9, Table	ND	ND	ND	ND	Negative

200903-05-112 12 Room 108, Row A, Seat 5	ND	ND	ND	ND	Negative
200903-05-113 13 Room 108 Podium	ND	ND	ND	ND	Negative
200903-05-114 14 Room 108 Outside Door Handle	ND	ND	ND	ND	Negative

**242 Terrace Boulevard, Suite B-1, Voorhees, New Jersey 08043 Tel: 856-767-8300 www.Prestige-EM.com Page 1 of 2**

*Prestige EnviroMicrobiology, Inc.*

200903-05-115 15 Room 108 Inside Door Handle	ND	ND	ND	ND	Negative
--	----	----	----	----	----------

**RT-PCR 2019-nCoV: Analysis of Air samples for the detection of SARS-CoV-2 Genetic Markers**

Prestige # Client sample ID Location	2019-nCoV (N1 Protein)	Cycle Threshold (Ct) Value <sup>3</sup> (N1 Protein)	2019-nCoV (N2 Protein)	Cycle Threshold Value <sup>3</sup> (N2 Protein)	Result
200903-05-105 05 TLH1 Air Sample (Front of Lecture Hall)	ND	ND	ND	ND	Negative
200903-05-106 06 TLH2 Air Sample (Front of Lecture Hall)	ND	ND	ND	ND	Negative
200903-05-107 07 Room 108 Air Sample Front Room	ND	ND	ND	ND	Negative

Report approved:

  
Theresa Lehman, MPH, Lab Director

Technical Manager: \_\_\_\_\_

  
Chin S Yang, Ph.D.

Analyst: Ching-Yi Tsai, Ph.D.

1. The samples in this report were received in good, acceptable conditions. Results relate only to the items tested.
2. The primers and probes in 2019-nCoV CDC EUA Kit are designed for the detection of the two SARS-CoV-2 genes that encode for the N1 and N2 proteins. The kit is manufactured and supplied by Integrated DNA Technologies and approved by the U.S. Centers for Disease Control and Prevention (CDC). Three controls, two positive controls for N proteins and one internal control for the RNA extraction process, are simultaneously run with the samples.
3. Cycle Threshold Value refers to the number of cycles required for the fluorescent signal to cross the detectable threshold in Reverse Transcriptase Polymerase Chain Reaction (RT-PCR); a lower cycle threshold value indicates a higher viral load.
4. ND = not detected, no genetic marker is detected within 40 PCR cycles. The detection limit is 10 copies/reaction.
5. Sampling reference: Rahmani, A. R., M. Leili, G. Azarian, A. Poormohammadi. 2020. Sampling and detection of corona viruses in air: A mini review. Science of the Total Environment.  
<https://doi.org/10.1016/j.scitotenv.2020.140207>

**242 Terrace Boulevard, Suite B-1, Voorhees, New Jersey 08043    Tel: 856-767-8300    www.Prestige-EM.com**  
Page 2 of 2